

CHAMBERLAIN®

The Protector System is designed to increase the safety and functionality of your garage door motor.

The system uses an invisible beam across the garage door opening. If an obstruction breaks the light beam while the door is closing, the door will stop and reverse to full open position.

NOTE: The brackets must be connected and fastened so that the sending and receiving eyes face each other.

The brackets must be securely fastened to a solid surface such as the studs on either side of the door, or add a piece of wood at each location if installing in masonry construction.

The invisible light beam path must be unobstructed. Ensure no part of the door (or door tracks, springs, hinges, rollers or other hardware) interrupts the beam while the door is closing. If it does, add a piece of wood to build out each sensor mounting location to the minimum depth required for light beam clearance.

To protect small children, install the Protector System™ no higher than (100 mm) above the floor. For Commercial door an additional beam is required at 650 mm. Disconnect power to the door opener before installing the Protector System.™

Assembly Process:

The IR Beams are supplied preassembled, complete with two sensors, wiring and wall brackets (fig 2 & fig 3).

Install the mounting brackets and sensors to either side of the inside of the garage door, and at a height of no greater than 100 mm off the garage floor.

The brackets are designed to be used for Wall or Floor fixing with a variety of hole combinations to achieve the desired results.

Drill the required holes and install the brackets with wall plugs and screws provided. Ensure they do not obstruct the door movement.

Wiring Process:

Align the Sensors to face each other and tighten if necessary. The wiring should exit from the bottom of the housing to maintain the correct IP rating and continued operation.

One sensor is a Sending Eye, the other is a Receiving Eye. Try to avoid positioning these indirect sunlight as this may interfere with the operation of the beams.

Run both sets of wires back to the power head CONTROL PANEL. Ensure the wires are well supported and do not interfere or get damaged by movement of the door panels or spring hardware.

At the Power head end, cut the wires to the correct length and strip each wire back around 15 mm.

Twist both White wires together and install into "quick release" terminal (white).

Twist both Black wires together and install into "quick release" Terminal (Grey).

For Specific Connections for each product, refer to the following pages, or to your Product Handbook.

Activation:

After the Protector System has been connected to the powerhead, the system will be automatically activated.

The Protector System™
Safety Reversing Sensor
Model 774ANZ
Model 774AML

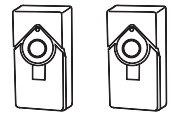

Review all safety warnings outlined in your Garage door operator owner's manual. Ensure that the door and all its fixtures and fittings are in good condition.

For Commercial doors ensure the door works well in manual operation.

Figure 1

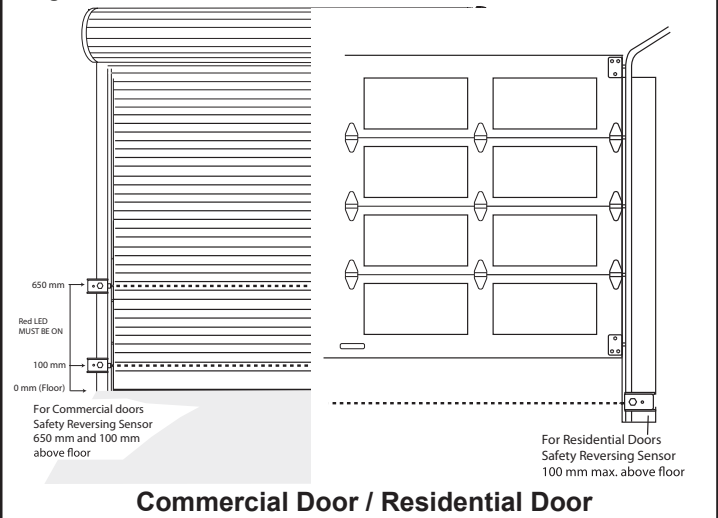

Commercial Door / Residential Door

Figure 2

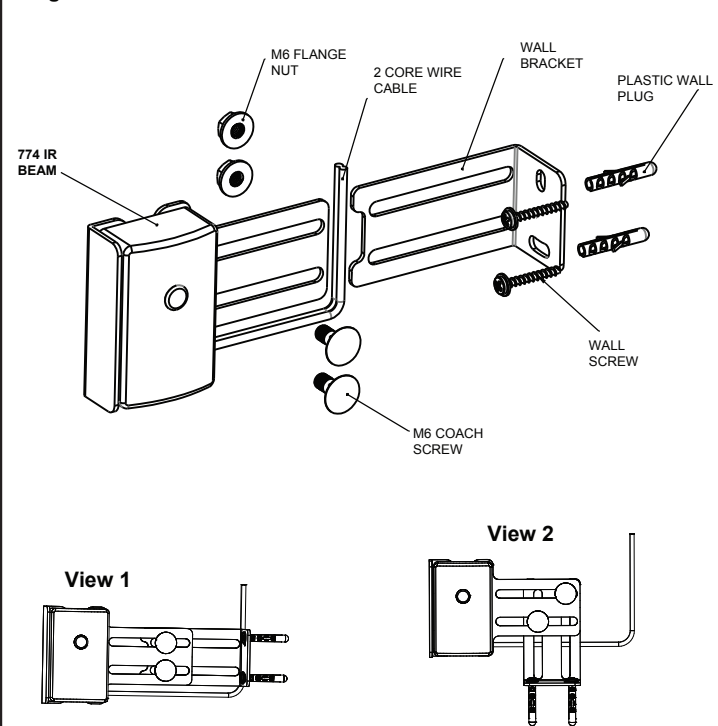
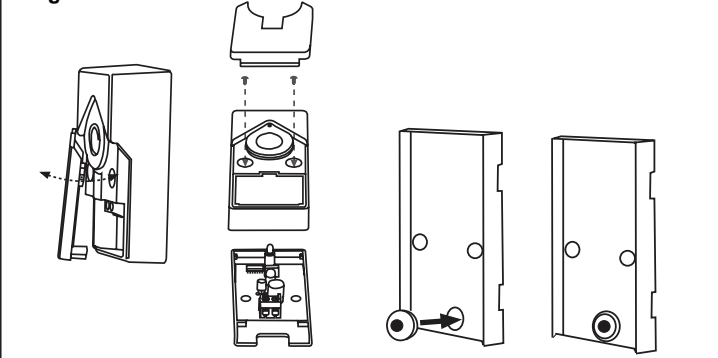
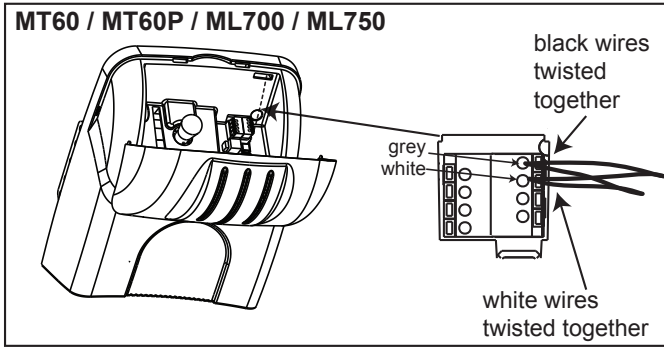

Figure 3



Wiring Connections Merlin Professional

MT60 / MT60P / ML700 / ML750



MT60/P connections (Chamberlain DIY - ML700 & ML750)

Open the lens cover on the front of the unit to access the connection terminals. Strip all wires back about 15 mm then twist the two white wires and the two black wires together.

Use a small screwdriver or pen to hold down the spring terminals, insert the black wires into the grey terminal, then terminate the white wires into the white terminal.

MT5580/P

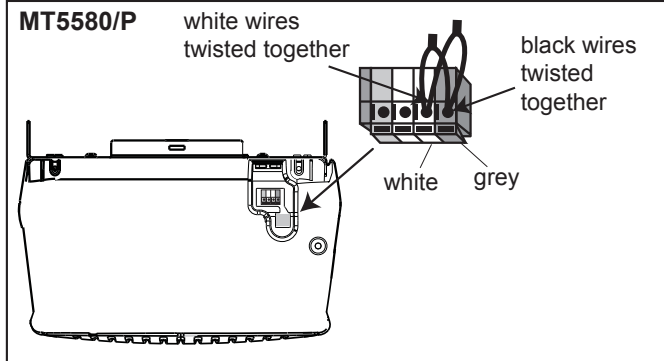

MT5580/P connection

Locate the connection terminals on the back of the unit. Strip all wires back about 15mm then twist the two white wires and the two black wires together.

Use a small screwdriver or pen to hold down the spring terminals, insert the black wires into the grey terminal, then terminate the white wires into the white terminal.

MT600 / MT1000

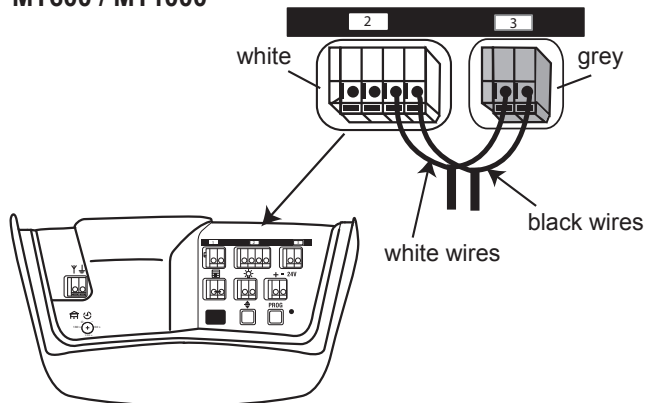

MT600 / MT1000 connections

Locate the terminals on the back of the unit. Strip all wires back about 15mm then twist the two white wires and the two black wires together.

Use a small screwdriver or pen to hold down the spring terminals, insert the black wires into the grey terminal (3), then terminate the white wires into the white terminal (2).

NOTE: Optional connections: Connect the white wires and black wires into separate terminal on the back of the unit as illustrated above. This may be required if larger diameter cable extensions have been used to extend wiring.

MR800 / MR60 / HE60R / CR550 / MLR500 MLR750 / CR600

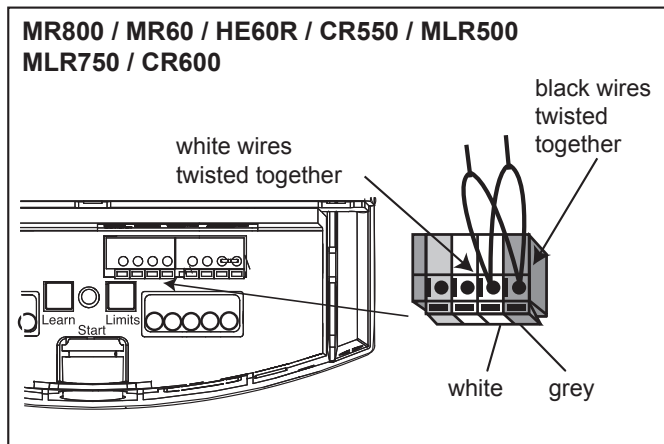

MR60 / MR800 connections (Chamberlain DIY HE60R / CR550 / MLR750 / MLR500 / HandyLift - CR550 / HandyLift Plus - CR600)

Gently lift the diffuser on the base of the motor to access the terminals. Strip all wires back about 15mm then twist the two white wires and the two black wires together.

Use a small screwdriver or pen to hold down the spring terminals, insert the black wires into the grey terminal, then terminate the white wires into the white terminal.

Wiring Connections Merlin Professional

MJ3800/R

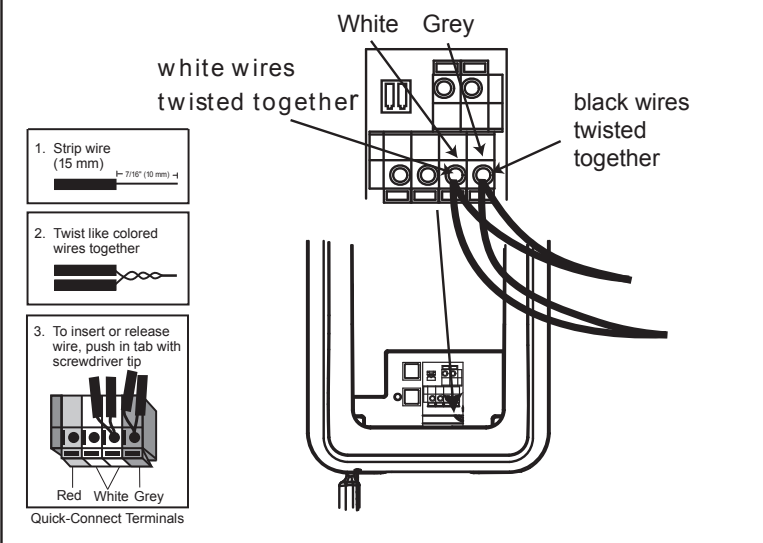

MJ3800/R connections

Gently lift the cover flap at the base of the motor to access the terminals. Strip all wires back about 15mm then twist the two white wires and the two black wires together. Use a small screw driver or pen to hold down the spring terminals, insert the black wires into the grey terminal, then terminate the white wires into the white terminal.

MT120EVO/ MT100EVO/ MT60EVO CS60EVO/ CS100EVO

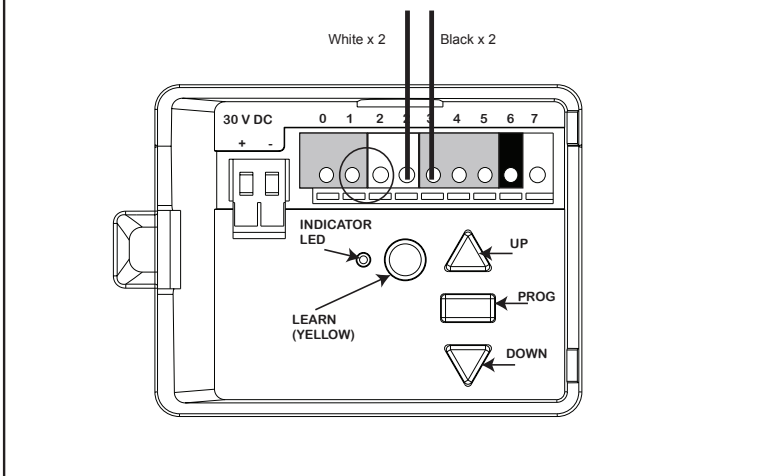

CyclonePro MT120EVO / Tiltmaster MT120EVO / PowerAce MT60EVO connections (Chamberlain DIY PowerLift CS60EVO / PowerLift Plus CS100EVO)

Locate the terminals on the back of the unit. Strip all wires back about 15 mm then twist the two white wires and the two black wires together. Use a small screwdriver or pen to hold down the spring terminals, insert the black wires into the grey terminal (3), then terminate the white wires into the white terminal (2).

MRC950EVO / MR850EVO / MR650EVO / CR650EVO

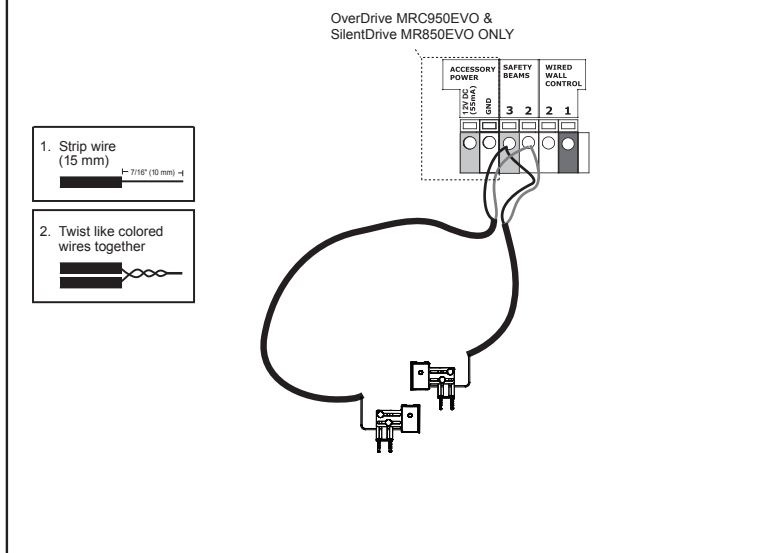

OverDrive MRC950EVO / SilentDrive MR850EVO / QuietDrive MR650EVO (Chamberlain DIY HandyLift Deluxe CR650EVO)

Gently lift the cover on the base of the motor to access the terminals. Strip all wires back about 15mm then twist the two white wires and the two black wires together. Use a small screwdriver or pen to hold down the spring terminals, insert the black wires into the grey terminal, then terminate the white wires into the white terminal.

Note: This model may need to be manually initialised. Please refer to your product handbook.

Wiring Connections Merlin Professional

MT3850EVO

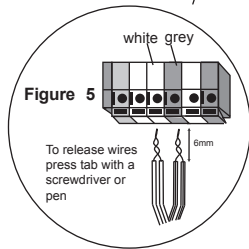
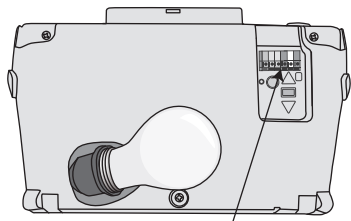

WhisperDrive MT3850EVO connection

Locate the connection terminals on the side of the unit
Strip all wires back about 15mm then twist the two white wires and the two black wires together.

Use a small screwdriver or pen to hold down the spring terminals, insert the black wires into the grey terminal, then terminate the white wires into the white terminal.

Note: This model may need to be manually initialised. Please refer to your product handbook.

MT50EVO / ST50EVO

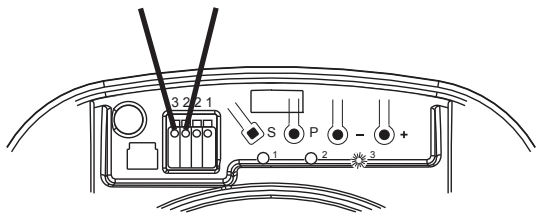
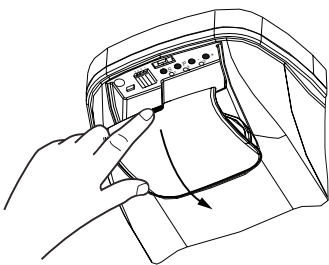

EntryLift MT50EVO & ST50EVO connection

Open the lens cover on the front of the unit to access the connection terminals. Strip all wires back about 15 mm then twist the two white wires and the two black wires together.

Use a small screwdriver or pen to hold down the spring terminals, insert the black wires into the grey terminal (3), then terminate the white wires into the white terminal (2).

Note: This model may need to be manually initialised. Please refer to your product handbook.

TEST THE PROTECTOR SYSTEM™

- Press the remote control push button to open the door.
- Place an object large enough to obstruct the sensor beam in the path of the door.
- Press the remote control push button to close the door.
The door will not move more than 40mm.

The door opener will not close from a remote control if the indicator light in either sensor is blinking (alerting you to the fact that the sensor is misaligned or obstructed).

Note: After the beams are initialised they are fail safe i.e. if they are removed, the motor will not close until the beams are re-installed.

Chamberlain Australia Pty Ltd
PO Box 1446
Lane Cove NSW 1595
gomerlin.com.au

Chamberlain New Zealand Ltd
P.O. Box 100221
North Shore 0745
gomerlin.co.nz

TROUBLE SHOOTING

1. If the *sending eye* or *receiving eye* indicator light does not glow after installation, check for:
 - Electric power to the opener.
 - A short in the black/white wires. These can occur under staples or at screw terminal connections.
 - Incorrect wiring between sensors and opener.
 - An open wire, (wire break).
 - Lock switch on Multi-Function Door Control Panel is activated. Deactivate.
2. If both sensors are blinking, realign or remove obstruction.
3. Once an infrared sensor has been installed the motor will only operate whilst it is installed correctly.
4. **If the IR sensors are damaged and cannot be repaired:**

Reset the Beam Input

To reset the beam input:

- * Remove all PE beam wires from the motor.
- * Turn power off for 2 seconds
- * Turn power on for 2 seconds
- * Turn power off for 2 seconds

Turn the power back on and test your motor, it should open and close using the remote control.

